

<b>Type</b>	<b>S10-M</b> I/O socket for IRC relays, 16 A Logic connection , 2 x A2
<b>Rated current</b>	<b>16 A</b>
<b>Specifications</b>	
Rated load	16 A / 250 V
Insulation	Test voltage V rms / 1 min
– All terminals/DIN rail	5 kV
Contact / Coil terminals	5 kV
Cross-section of connecting wire	
– Single-wire	4 mm <sup>2</sup> or 2 x 2,5 mm <sup>2</sup>
– Multi-wire	22 - 14 AWG
Max. screw torque	1,2 Nm
Screw dimensions	M3, Pozi, slot
Integrated retaining clip/plastic	for relay series C10, CSS
Labelling space	detachable
Connection label	1...6; DIN/EN
Mounting	DIN rail TS35 or mounting plate
Ambient temperature operation/storage	-40 (no ice)....60 °C / -40 ... 80 °C

**Socket for plug-in 10A IRC relays** **C10A, C10G, C10T and CSS**

**Accessories**

Coil bridge bars

V10-G, V40-G  
V10-R, V40-R  
V10-A, V40-A  
B20-G, B20-R  
B20-A

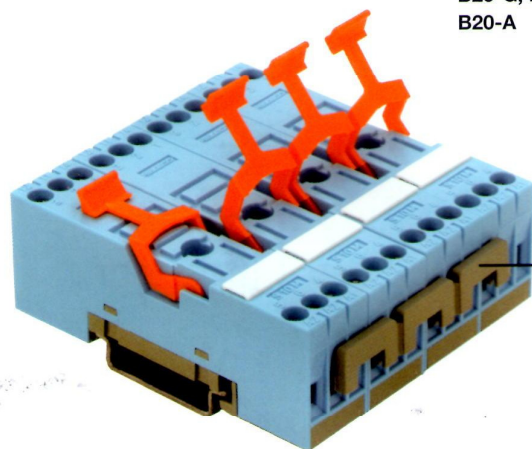
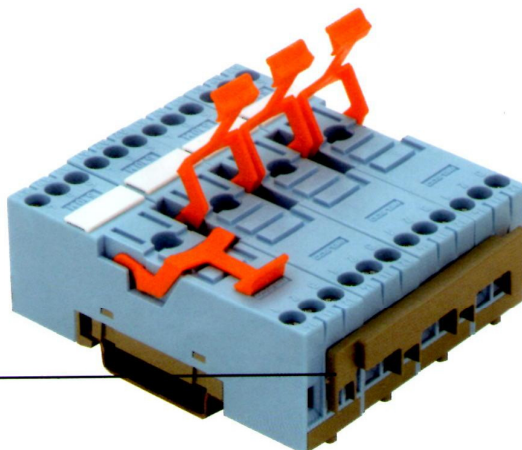
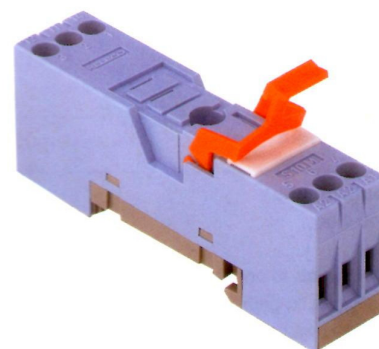
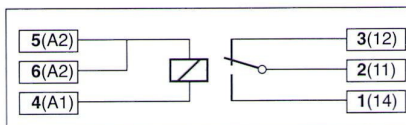
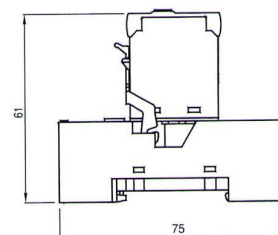
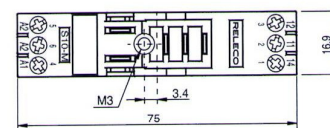
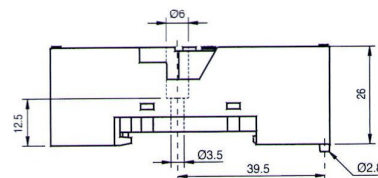
**COIL BRIDGE BARS****POWER BRIDGE BARS****Connection diagram****Dimensions [mm]****Technical approvals, conformities**

IEC 61810 EN 60947